

Sculptural Table & Integrated Bench



- Ships disassembled for freight savings
- Made in Austin, TX
- **** ADA **** compliant on ends on 40" wide tables
- Steel frame with 24 powder coat finishes
- Accoya, IPE, and other wood options.
- Most common sizes are 36" W x 42" L x 30" H and 72" W x 110" L x 30" H
- Custom sizes available such as 4', 6', 8', 10' long tables

Specifications

Width: 36", 72"

Length: 42", 110"

Depth: 77.5"

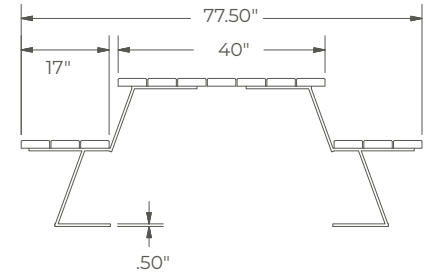
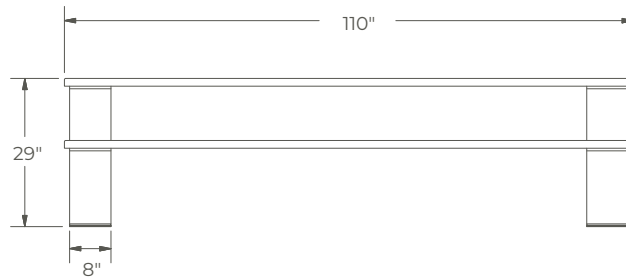

Available Finishes



Worksurface Options

